

CORTLANDT CROSSING

3144 EAST MAIN STREET, CORTLANDT MANOR, NY 10547

Cortlandt Crossing is the home of one of Westchester County's top ShopRite locations. The center is located on the north side of the highly-trafficked Route 6, approximately three miles west of the Taconic State Parkway. In addition to boasting great visibility and access, Cortlandt Crossing also features a brand new Homesense, as well as Chipotle, Verizon and Aspen Dental, and will be the future home of Buff City Soap.



PROPERTY INFORMATION

Type	Regional Shopping Center
GLA	+/- 128,000 sf
Tenants	ShopRite, HomeSense, Chipotle, Verizon, Aspen Dental

LEASING INFORMATION

DANNY ANNIBALE
Dannibale@acadiarealty.com
914.288.8173



411 Theodore Fremd Ave
Suite 300
Rye, NY 10580

CORTLANDT CROSSING

3144 EAST MAIN STREET, CORTLANDT MANOR, NY 10547

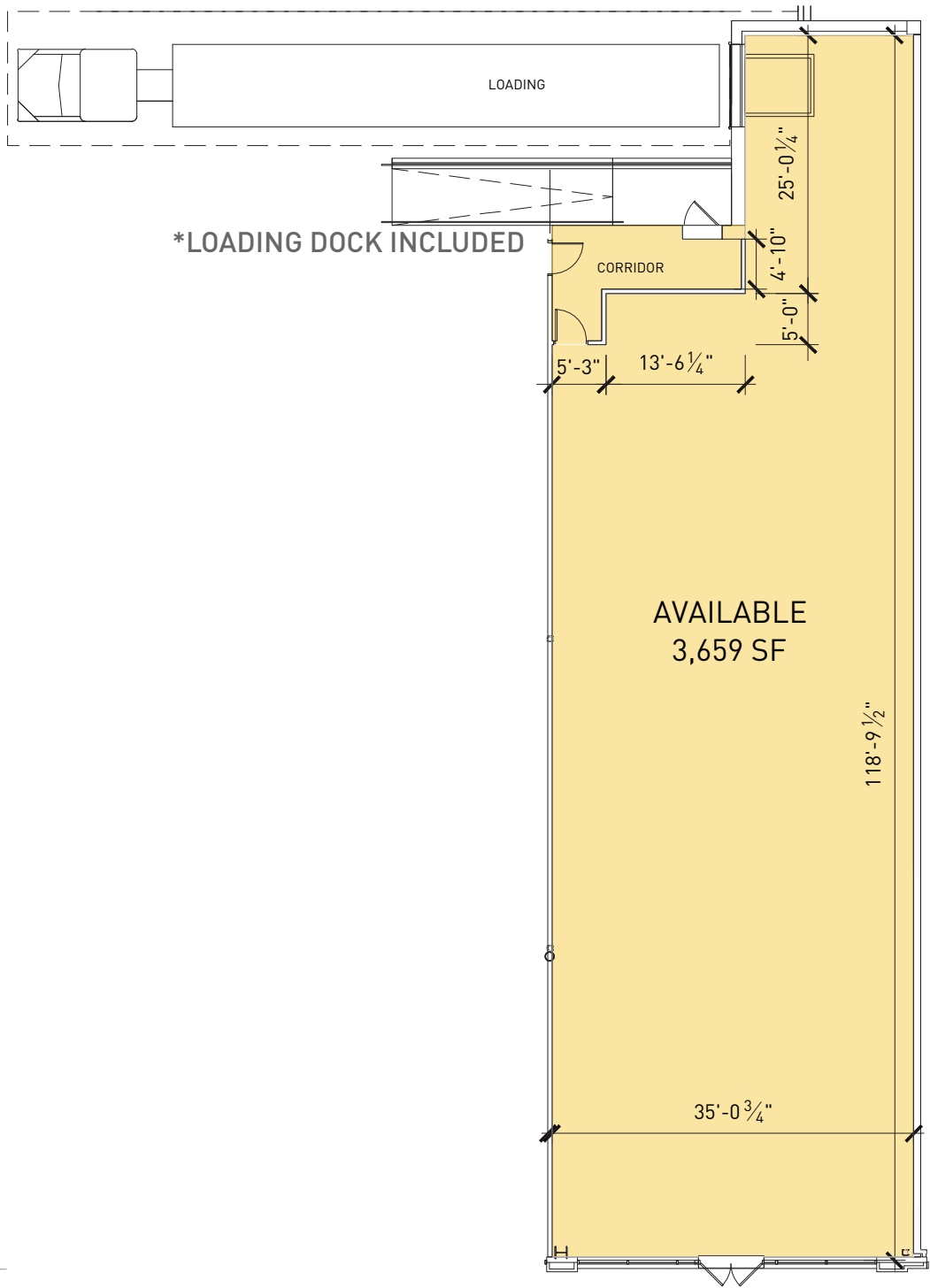

CORTLANDT CROSSING

3144 EAST MAIN STREET, CORTLANDT MANOR, NY 10547

TENANT ROSTER

1. Shoprite	67,868 sf
2a. Nail Salon	2,897 sf
2b. Sofia's Wash & Fold	2,551 sf
2c. Pulse MD	2,529 sf
2d. Available	3,659 sf
3. HomeSense	25,000 sf
4a. Chipotle	2,468 sf
4b. Aspen Dental	3,510 sf
5a. Verizon	2,000 sf
5b. At Lease	2,000 sf
5c. Buff City Soap	3,425 sf
6. Credit Union/Bank	PAD

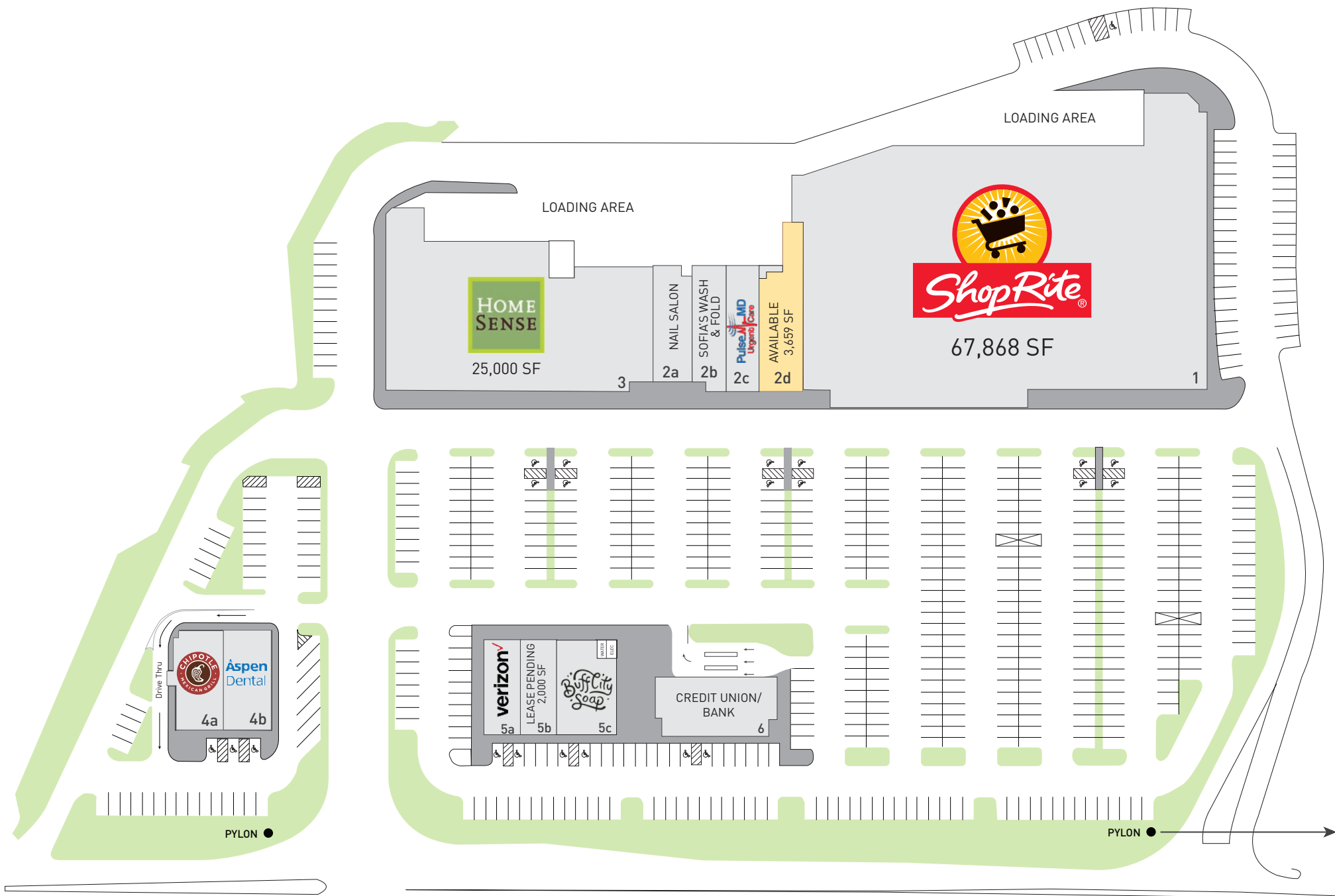

LEASED AVAILABLE

CORTLANDT CROSSING

3144 EAST MAIN STREET, CORTLANDT MANOR, NY 10547

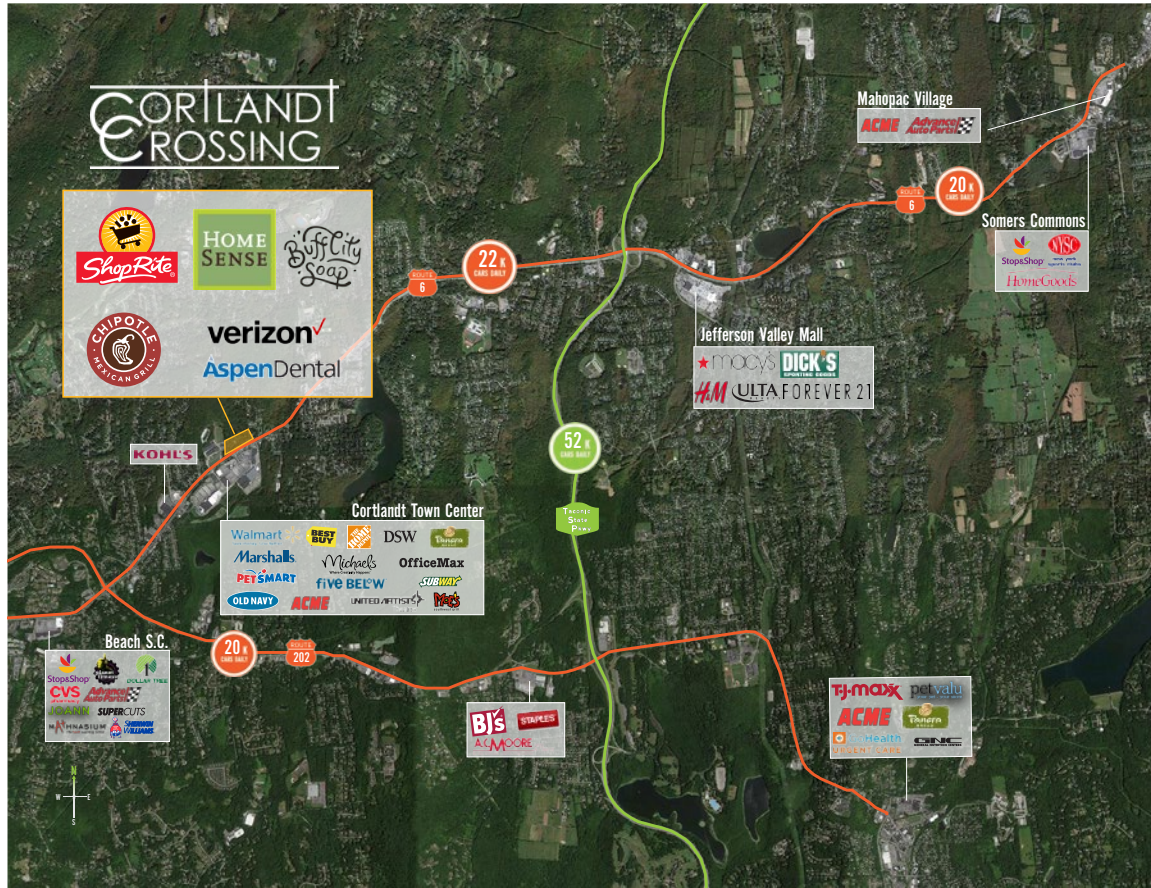

DEMOGRAPHICS

		5 MI.	10 MI.	15 MI.
POPULATION		91,059	245,333	543,851
HOUSEHOLDS		32,005	84,850	185,486
AVERAGE HHI		\$142,881	\$149,600	\$159,192